



- Capacities 1500 - 5000 kg
- Nickel plated alloy steel
- IP67 protection
- For use in tension and compression
- 6 wire (sense) circuit
- Output standardised to  $\pm 0.1\%$

**M**odel 619 is a low cost tension-compression load cell made from nickel plated alloy steel and is suitable for use in a wide range of weighing, process weighing, force measurement and industrial process control applications.

Protected to meet IP67 requirements, the construction of the 619 load cell allows its use in most industrial process applications. For IP68 requirements, select the fully-welded stainless steel model 620, which shares the same dimensions as model 619.

The additional sense wires compensate for changes in lead resistance due to temperature change and/or cable extension. Complete compensation of changes in lead resistance is achieved by feeding this voltage into appropriate electronics.

# 619

## Model 619 Tension compression load cell

# 619 SPECIFICATION

GRADE	E	F	G	UNITS
Rated Capacities	1500, 2000, 3000, 5000			kg
Rated Output	2.0 ± 0.1%			mV/V
Total Error	0.05	0.03	0.02	±% of Rated Output
Zero Return after 30 mins	0.05	0.03	0.017	±% of Applied Load
Temperature Effect : On Output	0.003	0.0014	0.0012	±% of Applied Load/°C
: On Zero	0.01	0.006	0.004	±% of Rated Output/°C
Zero Balance	5	3	2	±% of Rated Output
Temperature Range : Operating	-30 to +70			°C
: Compensated	-10 to +40			°C
Safe Overload	150			% of Rated Capacity
Ultimate Overload	300			% of Rated Capacity
Excitation : Recommended	10			Volts AC or DC
: Maximum	15			Volts AC or DC
Input Impedance	380 ± 20			Ohms
Output Impedance	350 ± 3			Ohms
Insulation Impedance	>2000			MegaOhms
Deflection at Rated Capacity	<0.4			mm
Weight	1500 and 2000 kg : 0.9		3000 and 5000 kg : 1.9	kg
Construction	nickel plated alloy steel			
Environmental Protection	IP67			
Cable	5m, 6 conductors, 26 AWG, Braid shield, PVC jacket			

## 619 Capacities 1500 kg and 2000 kg

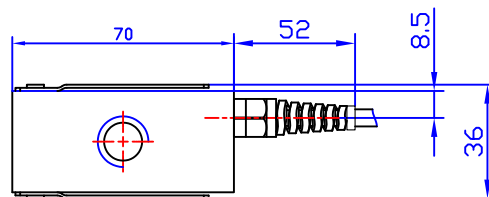
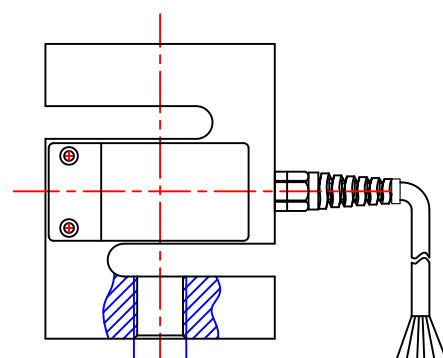
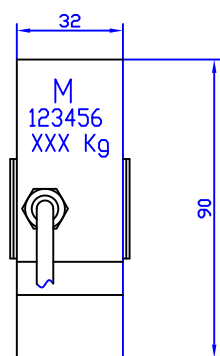

### Wiring Schematic Diagram (Balanced bridge configuration)

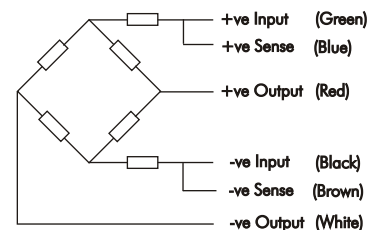

## 619 Capacities 3000 kg and 5000 kg

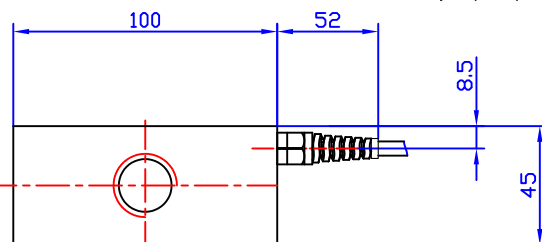
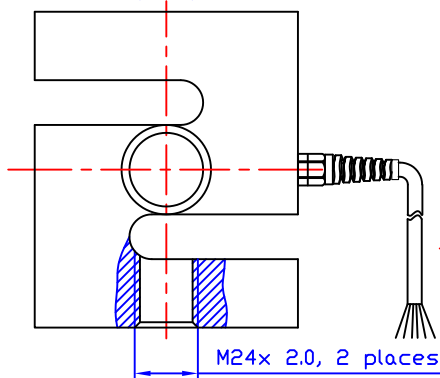
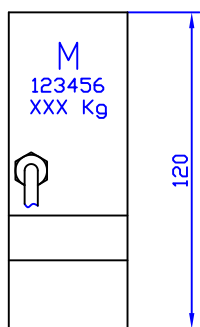

Due to Tedeo-Huntleigh's policy of continuous development, these specifications are subject to change without notice. Tedeo-Huntleigh is the world's leading manufacturer of high quality, high accuracy load cells in volume production. Our manufacturing facilities are ISO 9000 registered. For further details please contact Tedeo-Huntleigh or your local distributor, or visit our website at:

<http://www.tedeo-huntleigh.com>

### Europe

Tedeo-Huntleigh Europe Ltd.  
37 Portmanmoor Road,  
Cardiff  
CF24 5HE  
United Kingdom.  
Tel: +44(0)29-20460231  
Fax: +44(0)29-20462173

### International

Tedeo-Huntleigh International Ltd  
5 Hazoran St,  
New Industrial Zone  
P.O. Box 8381, Netanya 42506,  
Israel.  
Tel: +972-9-863-8888  
Fax: +972-9-863-8800

### China

Beijing Tedeo-Huntleigh.  
No. 16 Hong Da Bei Lu,  
Da Xing County, Beijing Economic  
& Technology Development Area,  
Beijing 100176. China  
Tel: +86-10-67881604-09  
Fax: +86-10-67881576

### Germany

Tedeo-Huntleigh GmbH.  
Mümlingweg 18  
D-64297  
Darmstadt-Eberstadt,  
Germany.  
Tel: +49-6151-94460  
Fax: +49-6151-944640

### USA

Tedeo-Huntleigh Incorporated.  
20630 Plummer Street,  
Chatsworth,  
California, 91311.  
USA  
Tel: +1-818-701-2700  
Fax: +1-818-701-2799

### France

SEEA sa.  
16 Rue Francis Vovelle  
28000 Chartres,  
France.  
Tel: +33-2-37-33-31-20  
Fax: +33-2-37-33-31-29

