



- Capacities 50-635kg
- Aluminium construction
- Single point
700 x 700mm platform
- IP67 protection
- Anodized for better
environmental protection
- OIML R60 approved

Model **1263** is a high performance, high capacity single point load cell designed for direct mounting of large weighing platforms.

The rugged construction offers high immunity to side forces making it suitable for a wide range of weighing applications, including bench scales, check weighing and process weighing.

A special humidity resistant protective coating assures long term stability over the entire compensated temperature range.

The 1263 provides scale manufacturers with a high accuracy low cost sensor to meet today's needs.

1263

Model 1263 Aluminium High Capacity single point load cell

1263 SPECIFICATION

GRADE	E	C3	UNITS
Rated Capacities	50, 100, 150, 200, 250, 300, 500, 635		kg
Rated Output	2.0±10%		mV/V
Total Error*	0.030	0.020	±% of Rated Output
Zero Return after 30 mins	0.050	0.017	±% of Applied Load
Temperature Effect : On Output	0.0030	0.0010	±% of Applied Load/°C
: On Zero	0.0100	0.0023	±% of Rated Output/°C
Eccentric Loading	0.0042	0.0028	±% of Applied Load/cm
Zero Balance	2.5		±% of Rated Output
Temperature range : Operating	-30 to +70		°C
: Compensated	-10 to +40		°C
Safe Overload	150		% of Rated Capacity
Ultimate Overload	250		% of Rated Capacity
Excitation : Recommended	10		Volts AC or DC
: Maximum	15		Volts AC or DC
Input Impedance	405 ±15		Ohms
Output Impedance	350±3		Ohms
Insulation Impedance	>5000		MegaOhms
Deflection at Rated Capacity	<0.4		mm
Weight : All Types	1.6		kg
Construction	Anodised Aluminium		
Environmental Protection	IP67		
Cable	1.5 Metres (Standard), 4 wire, PVC Jacket, Dual Floating Screen 6 Wire, Available On Request		
Platform	700 x 700		mm

*Total Error - According to OIML R60 Recommended torque 16 NM

All dimensions in mm

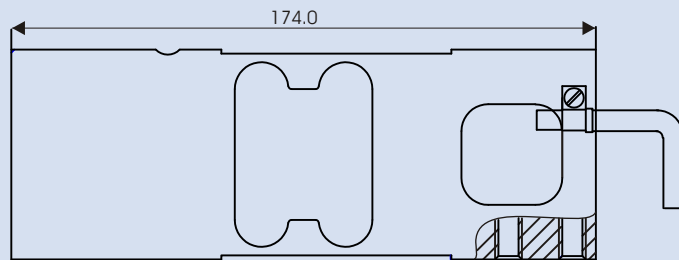
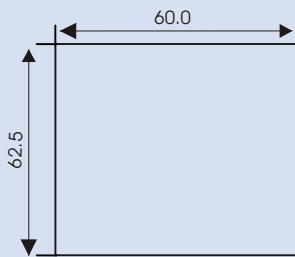

Wiring Schematic Diagram

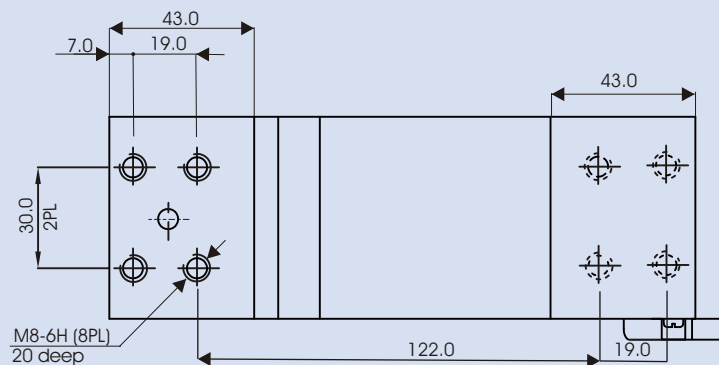
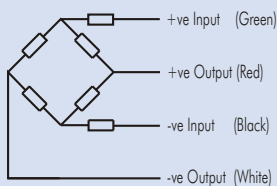

Due to Tedeia-Huntleigh's policy of continuous development, these specifications are subject to change without notice.

For larger platform sizes, high capacity load cells, designated the models 1320 and 1330 are available from Tedeia-Huntleigh.

Constructed in aluminium and sealed to IP66, it is ideally suited for platform scales.

For further details please contact Tedeia-Huntleigh or your local distributor, or visit our website at:

<http://www.tedeia-huntleigh.com>

Europe

Tedeia-Huntleigh Europe Ltd.
37 Portmanmoor Road,
Cardiff
CF24 5HE
United Kingdom.
Tel: +44(0)29-20460231
Fax: +44(0)29-20462173

International

Tedeia-Huntleigh International
5 Hazoran St,
New Industrial Zone
PO. Box 8381, Netanya 42506,
Israel.
Tel: +972-9-863-8888
Fax: +972-9-863-8800

China

Beijing Tedeia-Huntleigh.
No. 16 Hong Da Bei Lu,
Da Xing County, Beijing Economic
& Technology Development Area,
Beijing 100176. China
Tel: +86-10-67881604-09
Fax: +86-10-67881576

Germany

Tedeia-Huntleigh GmbH.
Mümlingweg 18
D-64297
Darmstadt-Eberstadt,
Germany.
Tel: +49-6151-94460
Fax: +49-6151-944640

USA

Tedeia-Huntleigh Incorporated.
20630 Plummer Street,
Chatsworth,
CA 91311
USA.
Tel: +1-818-701-2700
Fax: +1-818-701-2799

France

SEEA sa.
16 Rue Francis Vovelle
28000 Chartres,
France.

Tel: +33-2-37-33-31-20
Fax: +33-2-37-33-31-29

TEDEA 
HUNTLEIGH
EXCELLENCE IN LOAD CELLS